

LOT 80
(NOT INCLUDED)

- LEGEND**
- = SET IRON ROD
 - ⊙ = SET P.K. & K.L.S. DISK
 - ◻ = WATER METER
 - = WOOD POWER POLE

SCALE 1" = 30'

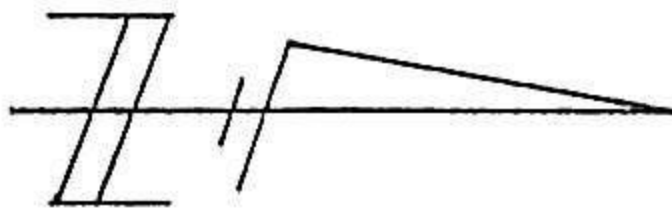

14° 33' 20" W
4 OLD DIXIE HWY.

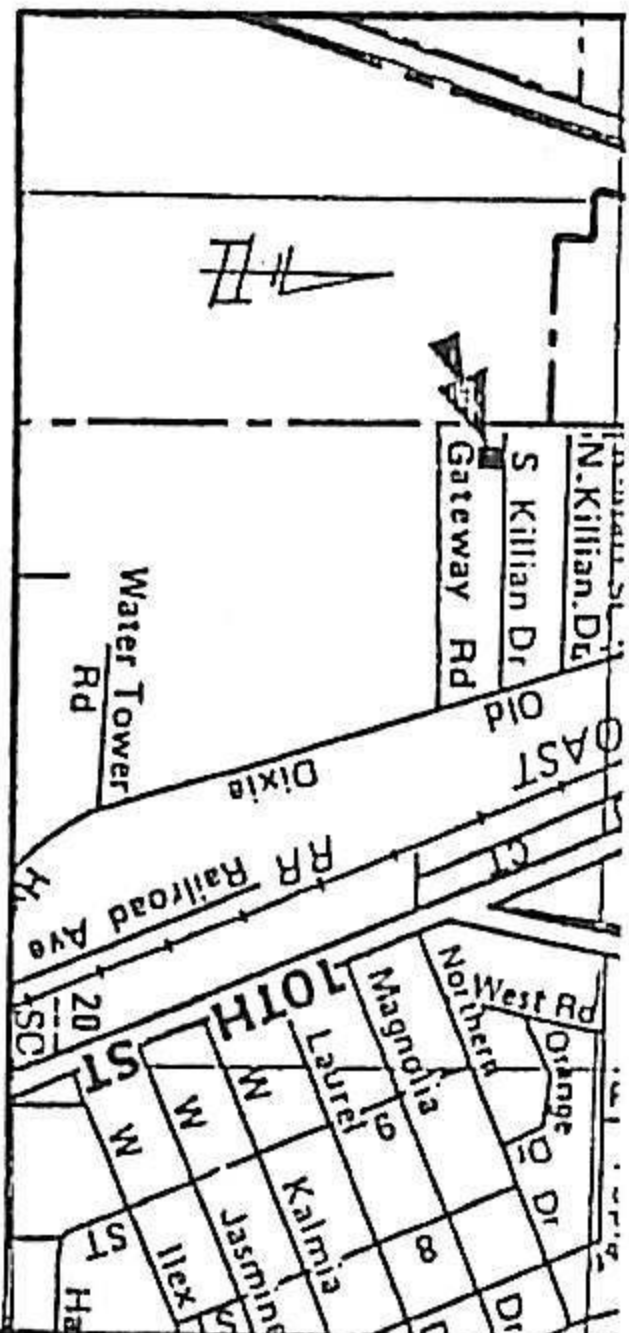

VICINITY SKETCH
N.T.S.

DESCRIPTION

LOTS 77, 78 AND 79, ACCORDING TO THE PLAT OF NORTHLAKE BUSINESS PARK, AS RECORDED IN PLAT BOOK 30, AT PAGE 94, IN AND FOR THE PUBLIC RECORDS OF PALM BEACH COUNTY, FLORIDA.
SUBJECT TO RIGHTS-OF-WAY, EASEMENTS AND OTHER MATTERS OF RECORD.